

PROJECT DATA SHEET

Sports Complex

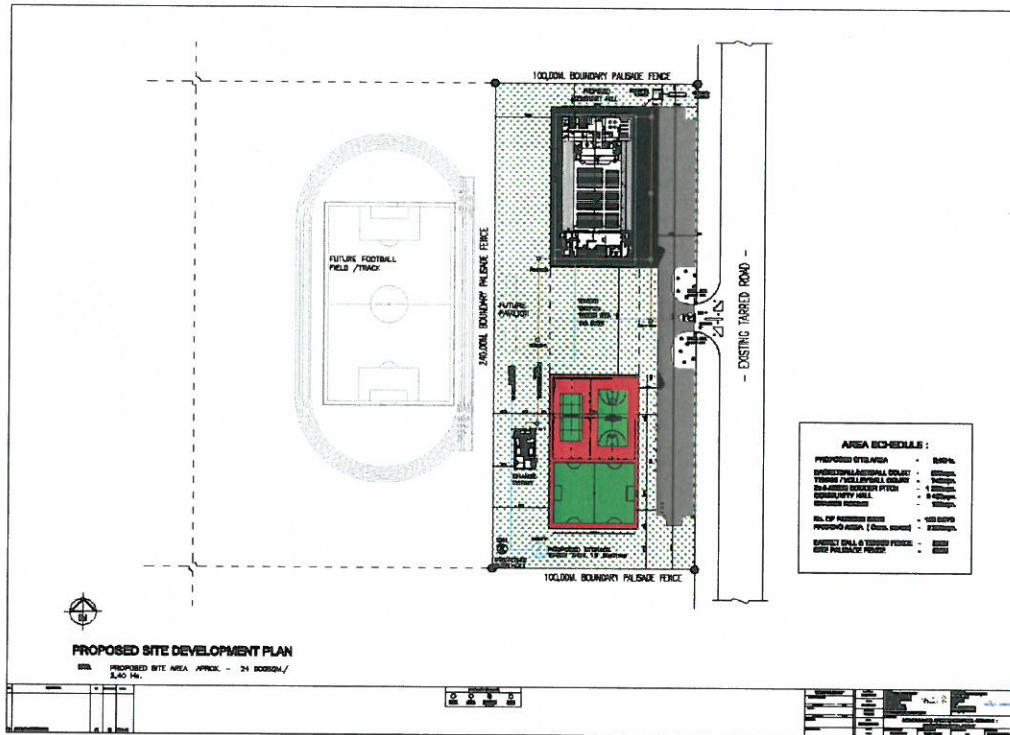

CLIENT	: POLOKWANE MUNICIPALITY
PROJECT	: GA-MAJA SPORTS COMPLEX
LOCATION	: GA-MAJA, WARD 2, MAJA CLUSTER
VALUE	: R 20.0 million
COMPLETION	: JUNE 2016
SCOPE OF SERVICE	: INVESTIGATION/ DESIGN/DOCUMENTATION/PROJECT MANAGEMENT & CONSTRUCTION MONITORING

PROJECT DETAILS

Tlou Consulting (Pty) Ltd was appointed by the Polokwane Municipality in October 2013 for the planning, design and project management of the Maja Sports Complex. The terms of reference included:

- Feasibility study and compilation of Municipal Infrastructure Grant business plan,
- Development of detail design report and final tender documentation, and
- Contract management

The scope of construction works comprised:

- Community Hall (1000 Seater)
- Multi-purpose all-weather sports courts (for the disciplines of soccer, netball, basketball, volleyball)
- Ablutions/Change Room
- Storeroom/Equipment Room
- Caretaker/Supervisor Accommodation